

## Pipe Fittings

### Advantages

All pipe fitting threads are made to Dryseal standards.\* Connectors, unions, nuts and extruded elbows and tees are machined from CA 360 and CA 345 brass; forged elbows and tees are machined from CA 377 brass.

### Specifications

Meets functional requirements of the SAE J530, SAE J531, ASME and ASA.

### Applications

Use with brass, copper or iron pipe. Manufactured for low and medium pressure line connection work.

### Working Pressure and Temperature Ranges

From -65° to +250°F. at 1000 psi.

### Vibration

Fair resistance to vibration and pipe movement depending upon conditions.

### Order

By part number and name.

### Nomenclature

Part numbers are constructed from symbols that identify the style and size of the fitting. The first series of numbers and letters identifies the style and type fitting. The second series of numbers describes the size.

#### Example:

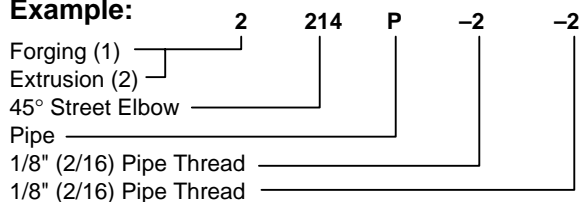

### Sizes

Pipe sizes are determined by the number of sixteenths of an inch in the pipe size.

### Special Fittings

Fitting configurations and/or sizes other than those shown in the catalog can be furnished. It is suggested that a print or sketch be submitted with the inquiry.

### Pricing

Only items prices in current supplementary price list PL3501 are carried in stock. Price and delivery for non-stock items furnished on request for specified quantity.

**Pipe thread assembly guide (turns method)  
for Dryseal threads with pre-applied Vibra Seal**

**Straight Fittings**

1. Tighten external thread into the internal thread.
2. Tighten an additional 2 revolutions with a wrench up to 1/2 in. male pipe thread. Above 1/2 in., 1 1/2 to 2 1/2 revolutions.

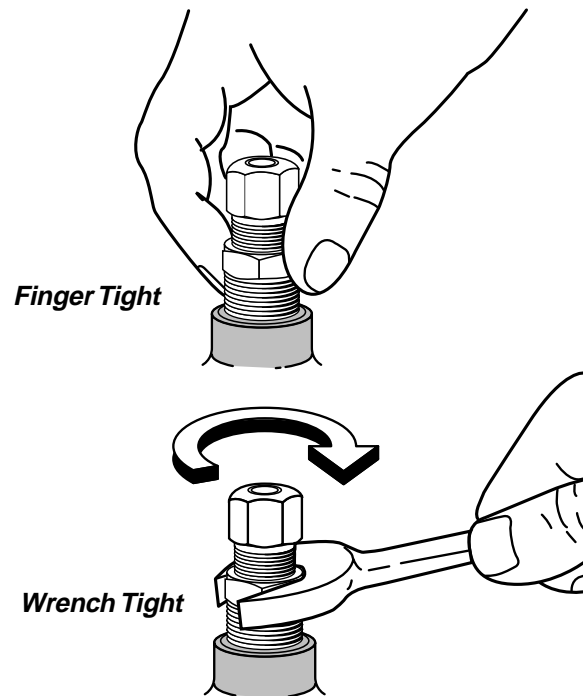

**Elbow or Tee Fittings**

1. Tighten external thread into the internal thread.
2. Tighten an additional 1 to 1 1/2 revolutions with a wrench.
3. Tighten fitting, Clockwise, to Align with Tubing (never counter clockwise).

*Note: To minimize the possibility of a leaking threaded joint after assembling male to female pipe threads, neither end should be backed out (loosened) once the assembly has been made.*

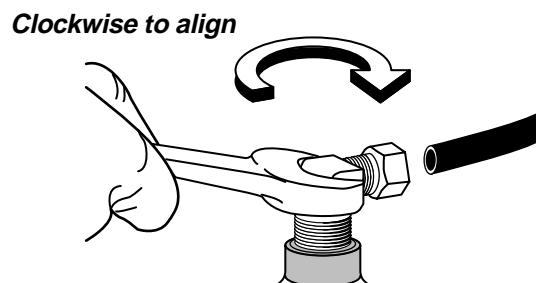
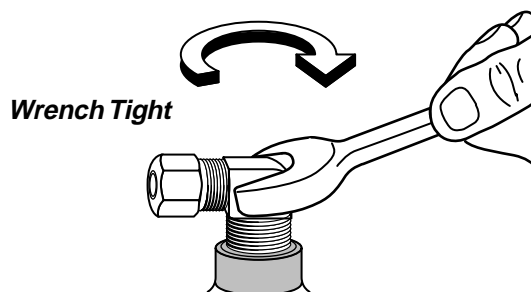
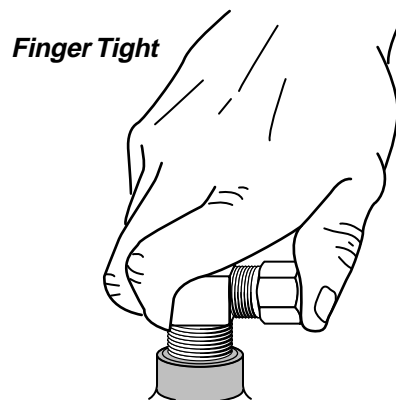

## Pipe Fittings

### Anchor coupling 207ACBH

PART NO.	PIPE THREAD	STRAIGHT THREAD	B HEX	C HEX	MAX BULKHEAD P	L	FLOW DIA. D
207ACBH-2	1/8	5/8-18	7/8	15/16	.89	1.50	.328
207ACBHS-2	1/8	5/8-18	7/8	15/16	.35	.96	.328
207ACBH-4	1/4	3/4-16	1	1-1/8	.81	1.50	.421
207ACBHS-4	1/4	3/4-16	1	1	.25	.94	.421
207ACBH-6	3/8	1.00-14	1-1/8	1-1/4	.62	1.31	.570
207ACBH-8	1/2	1-1/8-14	1-1/4	1-3/8	.75	1.50	.688

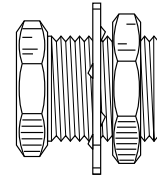
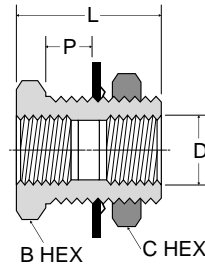

### Coupling 207P

Ref. SAE 130138

PART NO.	PIPE THREAD	C HEX	L	FLOW DIA. D
207P-2	1/8	9/16	.75	.328
207P-4	1/4	3/4	1.12	.422
207P-6	3/8	7/8	1.12	.562
207P-8	1/2	1-1/16	1.50	.688
207P-12	3/4	1-3/8	1.53	.900

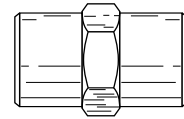
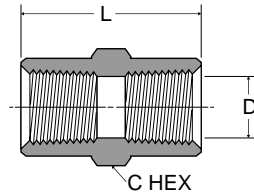

### Reducer coupling 208P

Ref. SAE 130138

PART NO.	1 PIPE THREAD	2 PIPE THREAD	C HEX	L	FLOW DIA. D
208P-4-2	1/4	1/8	3/4	.97	.328
208P-6-4	3/8	1/4	7/8	1.16	.422
208P-8-4	1/2	1/4	1-1/16	1.28	.422
208P-8-6	1/2	3/8	1-1/16	1.38	.562
208P-12-6	3/4	3/8	1-3/8	1.32	.562
208P-12-8	3/4	1/2	1-3/8	1.50	.688

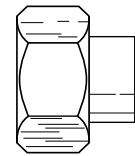
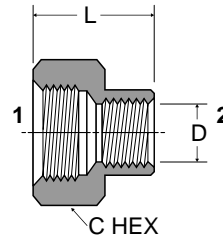

### Bushing 209P

Ref. SAE 130140

PART NO.	1 PIPE THREAD	2 PIPE THREAD	C HEX	L	FLOW DIA. D
209P-4-2	1/8	1/4	9/16	.75	.328
209P-6-2	1/8	3/8	11/16	.75	.328
209P-6-4	1/4	3/8	3/4	.75	.422
209P-8-2	1/8	1/2	7/8	1.00	.328
209P-8-4	1/4	1/2	7/8	1.00	.422
209P-8-6	3/8	1/2	7/8	1.00	.562
209P-12-2	1/8	3/4	1-1/8	1.00	.328
209P-12-4	1/4	3/4	1-1/8	1.00	.422
209P-12-6	3/8	3/4	1-1/8	1.00	.562
209P-12-8	1/2	3/4	1-1/8	1.00	.688
209P-16-8	1/2	1	1-3/8	1.31	.688

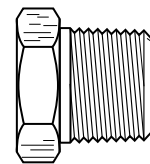
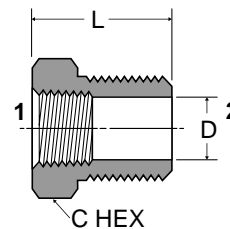

### Lock nut 210P

PART NO.	PIPE THREAD	C HEX	L
210P-2	1/8 NPSL	11/16	.19
210P-4	1/4 NPSL	7/8	.25
210P-6	3/8 NPSL	1	.25
210P-8	1/2 NPSL	1-1/8	.25

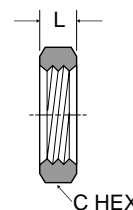

**Square-head Plug 211P**

PART NO.	PIPE THREAD	C	L	M
211P-2	1/8	9/32	.59	.25
211P-4	1/4	3/8	.80	.30
211P-6	3/8	15/32	.80	.30
211P-8	1/2	9/16	1.07	.39
211P-12	3/4	5/8	1.14	.45

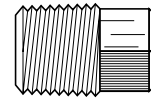
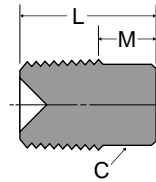

**Union 212P**

PART NO.	PIPE THREAD	C HEX	L	D
212P-4	1/4	1-3/16	1.53	.422
212P-6	3/8	1-1/4	1.79	.562

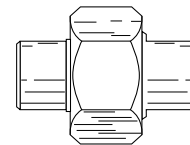
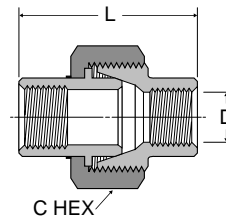

**Cap 213P**

PART NO.	PIPE THREAD	C HEX	L
213P-2	1/8	9/16	.50
213P-4	1/4	11/16	.63
213P-6	3/8	13/16	.63
213P-8	1/2	1-1/16	.87

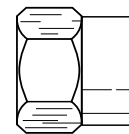
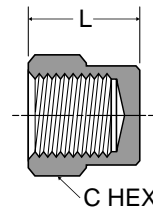

**Close nipple 215PN**

PART NO.	PIPE THREAD	L	FLOW DIA. D
215PN-2	1/8	.75	.281
215PN-4	1/4	.88	.375
215PN-6	3/8	1.00	.500
215PN-8	1/2	1.13	.625
215PN-12	3/4	1.31	.750

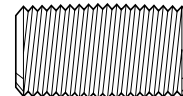
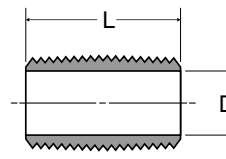

**Long nipple 215PNL**

PART NO.	PIPE THREAD	L	FLOW DIA. D
215PNL-2-15	1/8	1-1/2	.250
215PNL-4-15	1/4	1-1/2	.375
215PNL-6-15	3/8	1-1/2	.500
215PNL-8-15	1/2	1-1/2	.625
215PNL-2-20	1/8	2	.250
215PNL-4-20	1/4	2	.375
215PNL-6-20	3/8	2	.500
215PNL-8-20	1/2	2	.625
215PNL-2-25	1/8	2-1/2	.250
215PNL-4-25	1/4	2-1/2	.375
215PNL-6-25	3/8	2-1/2	.500
215PNL-8-25	1/2	2-1/2	.625
215PNL-2-30	1/8	3	.250
215PNL-4-30	1/4	3	.375
215PNL-6-30	3/8	3	.500
215PNL-8-30	1/2	3	.625
215PNL-2-35	1/8	3-1/2	.250
215PNL-4-35	1/4	3-1/2	.375
215PNL-6-35	3/8	3-1/2	.500
215PNL-8-35	1/2	3-1/2	.625

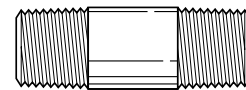
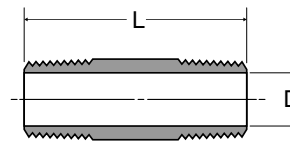

## Pipe Fittings

### Hex nipple 216P

Ref.SAE 130137

PART NO.	PIPE THREAD	C HEX	L	FLOW DIA.D
216P-2	1/8	7/16	.97	.220
216P-4	1/4	9/16	1.38	.314
216P-6	3/8	11/16	1.41	.440
216P-8	1/2	7/8	1.81	.564
216P-12	3/4	1-1/16	1.81	.752

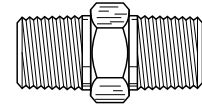
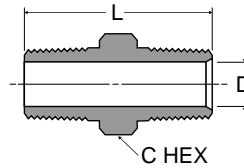

### Hex nipple reducers 216P

PART NO.	1 PIPE THREAD	2 PIPE THREAD	C HEX	L	FLOW DIA. D
216P-4-2	1/4	1/8	9/16	1.19	.220
216P-6-2	3/8	1/8	11/16	1.22	.220
216P-6-4	3/8	1/4	11/16	1.41	.314
216P-8-4	1/2	1/4	7/8	1.62	.314
216P-8-6	1/2	3/8	7/8	1.62	.440
216P-12-8	3/4	1/2	1-1/16	1.80	.564

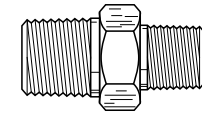
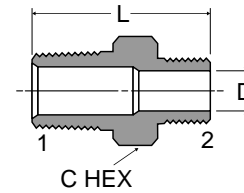

### Hex-head plug 218P

PART NO.	PIPE THREAD	C HEX	L
218P-2	1/8	7/16	.560
218P-4	1/4	9/16	.750
218P-6	3/8	11/16	.780
218P-8	1/2	7/8	.970
218P-12	3/4	1-1/16	1.063

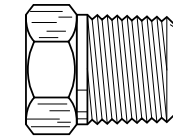
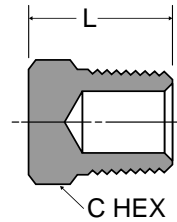

### Countersunk hex-head plug 219P

PART NO.	PIPE THREAD	C HEX	L
219P-2	1/8	3/16	.30
219P-4	1/4	1/4	.46
219P-6	3/8	5/16	.47
219P-8	1/2	3/8	.61
219P-12	3/4	9/16	.62

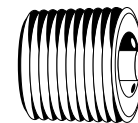
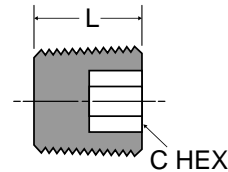

### Slotted-head plug 220P

PART NO.	PIPE THREAD	L
220P-2	1/8	.31
220P-4	1/4	.42
220P-6	3/8	.43

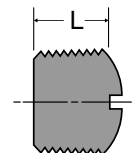

**Adapter 222P**

Ref. SAE 130139

PART NO.	1 PIPE THREAD	2 PIPE THREAD	C HEX	L	FLOW DIA. D
222P-2-2	1/8	1/8	9/16	.88	.218
222P-4-2	1/4	1/8	3/4	1.06	.218
222P-4-4	1/4	1/4	3/4	1.25	.314
222P-6-2	3/8	1/8	7/8	1.10	.218
222P-6-4	3/8	1/4	7/8	1.25	.314
222P-6-6	3/8	3/8	7/8	1.25	.440
222P-8-4	1/2	1/4	1	1.47	.312
222P-8-6	1/2	3/8	1-1/16	1.47	.440
222P-8-8	1/2	1/2	1-1/16	1.66	.562
222P-12-6	3/4	3/8	1-3/8	1.50	.440
222P-12-8	3/4	1/2	1-3/8	1.69	.562
222P-12-12	3/4	3/4	1-3/8	1.69	.751

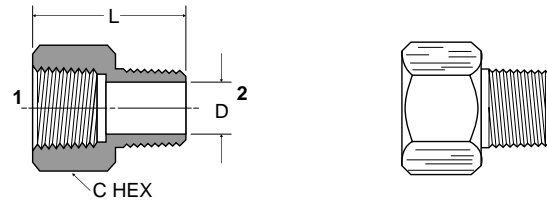

**90° union elbow 1200P-2200P**

Ref. SAE 130238

PART NO.	PIPE THREAD	M	FLOW DIA. D
1200P-2-2	1/8	.56	.328
2200P-2-2	1/8	.55	.328
1200P-4-4	1/4	.81	.422
2200P-4-4	1/4	.78	.422
1200P-6-6	3/8	.84	.562
2200P-6-6	3/8	.84	.563
2200P-8-8	1/2	1.09	.687

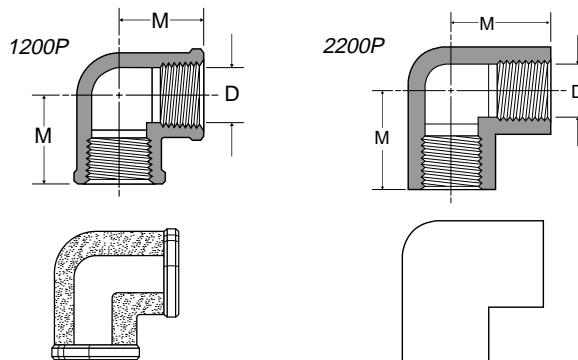

**90° street elbow 1202P-2202P**

Ref. SAE 130239

PART NO.	1 PIPE THREAD	2 PIPE THREAD	M	N	FLOW DIA. D
1202P-2-2	1/8	1/8	.81	.56	.220
2202P-2-2	1/8	1/8	.62	.48	.220
2202PA-2-2	1/8	1/8	.66	.48	.220
2202P-4-2	1/4	1/8	.72	.51	.209
1202P-4-4	1/4	1/4	1.08	.69	.314
2202P-4-4	1/4	1/4	.91	.45	.312
2202PA-4-4	1/4	1/4	.91	.72	.312
2202P-4-6	1/4	3/8	.97	.78	.438
1202P-6-6	3/8	3/8	1.25	.78	.428
2202P-6-6	3/8	3/8	.98	.54	.428
2202PA-6-6	3/8	3/8	.97	.78	.438
2202P-8-8	1/2	1/2	1.25	1.03	.552
2202P-12-12	3/4	3/4	1.38	1.10	.750

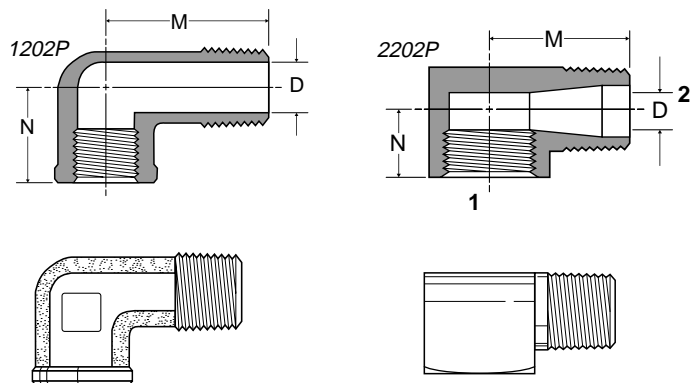

# Pipe Fittings

## Union tee 1203P-2203P

Ref. SAE 130438

PART NO.	PIPE THREAD	L	M	FLOW DIA.D
1203P-2	1/8	1.12	.56	.328
2203P-2	1/8	1.06	.53	.328
1203P-4	1/4	1.38	.69	.422
2203P-4	1/4	1.52	.76	.422
2203P-6	3/8	1.68	.84	.562
2203P-8	1/2	2.14	1.07	.687
2203P-12	3/4	2.28	1.14	.900

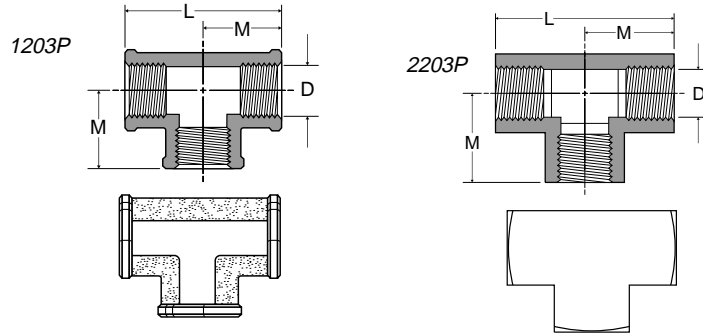

## Male elbow 1204P

PART NO.	PIPE THREAD	M	FLOW DIA.D
1204P-2	1/8	.71	.220
1204P-4	1/4	1.09	.312
1204P-6	3/8	1.09	.406
1204P-8	1/2	1.41	.562

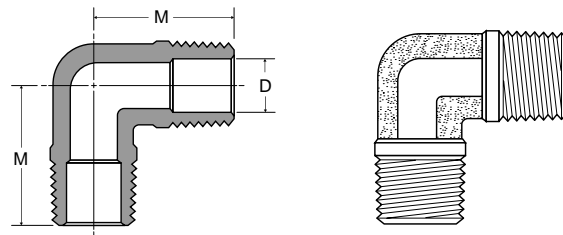

## Male branch tee 2224P

Ref. SAE 130425

PART NO.	PIPE THREAD	L	M	N	FLOW DIA.D
2224P-2	1/8	1.06	.53	.66	.220
2224P-4	1/4	1.52	.76	.91	.314
2224P-6	3/8	1.68	.84	.97	.438
2224P-8	1/2	2.18	1.09	1.26	.592

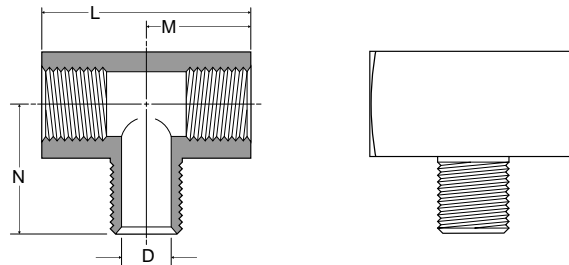

## Street tee 2225P

Ref. SAE 130424

PART NO.	PIPE THREAD	M	N	FLOW DIA.D
2225P-2	1/8	.55	.66	.220
2225P-4	1/4	.76	.91	.312
2225P-6	3/8	.82	.99	.440
2225P-8	1/2	1.07	1.27	.564
2225P-12	3/4	1.14	1.38	.750

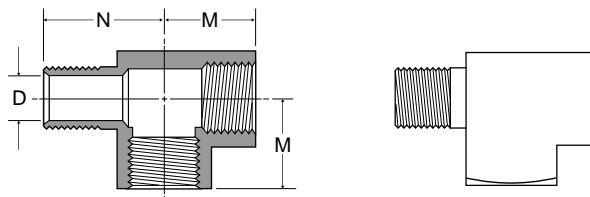

**Drop-ear 90° elbow 2200PDE**

PART NO.	PIPE THREAD	L	M	FLOW DIA.D
2200PDE-2	1/8	1.38	1.00	.328

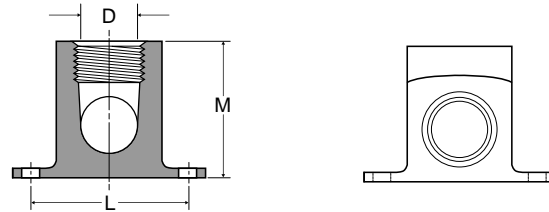

**45° female elbow 2201P**

PART NO.	PIPE THREAD	M	FLOW DIA. D
2201P-2-2	1/8	.43	.328

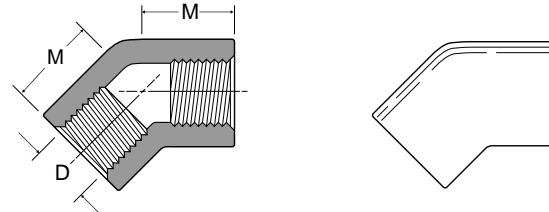

**Cross 2205P**

PART NO.	PIPE THREAD	M	FLOW DIA. D
2205P-2	1/8	.53	.328
2205P-4	1/4	.75	.421
2205P-6	3/8	.82	.562
2205P-8	1/2	1.07	.688
2205P-12	3/4	1.14	.900

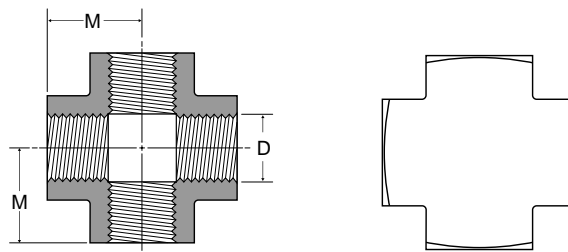

**45° street elbow 2214P**

Ref. SAE 130339

PART NO.	PIPE THREAD	M	N	FLOW DIA.D
2214P-2-2	1/8	.38	.50	.220
2214P-4-4	1/4	.54	.70	.314
2214P-6-6	3/8	.54	.78	.440
2214P-8-8	1/2	.73	1.00	.562
2214P-12-12	3/4	.73	1.04	.750

