

Mini Ball Valves Series 200/608/609

Advantages

The Parker Mini-Valve is to be used in confined and hard to reach applications. The Brass extruded body allows for extended service life and is chrome plated as standard. Features of the MV608/609 valves include blowout proof stem, hard chrome plate ball, PTFE seats, viton stem seals, and standard yellow handle. MV200 valve features a black lever handle. This economical ball valve is available in 1/8", 1/4", 3/8" and 1/2" sizes.

Applications

Parker's industrial ball valve product line is intended for general purpose use. Please be aware that ball valves are intended for use in the fully open or closed positions. Depending on application conditions, throttling of the valve may result in premature seal failure and/or inability to turn the valve handle.

For use on water and air service lines on capital equipment and plant design plumbing that require total shutoff capability.

Working Pressure and Temperatures

These valves are designed and built for use at pressures and temperatures within the stated ranges. Consult the factory for any use outside of these ranges.

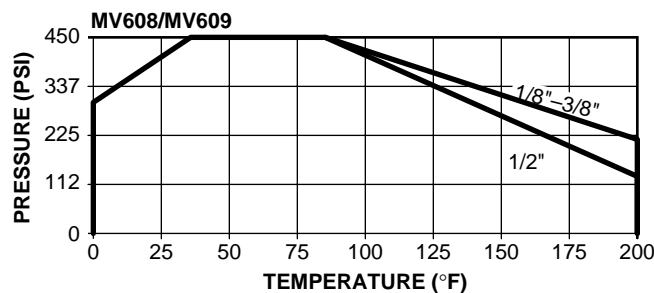
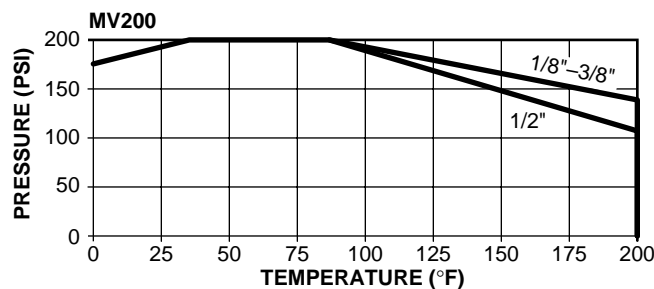

Operating Instructions

Quarter turn is "ON" or "OFF".
(Provides Positive stop action for full shutoff.)

Style	Type	Size
MV	608 609	-2
Style	MV-Mini Valve	
Type	608-Male/Female 609-Female/Female	
Handle Color	MV200 features a black lever handle MV608/MV609 features-yellow wedge handles	
Size	2-1/8" 4-1/4" 6-3/8" 8-1/2"	

Style	Type	Size
MV	200	-2
Style	MV-Mini Valve	
Type	200-Female/Female Lever Handle	
Size	2-1/8" 4-1/4" 6-3/8" 8-1/2"	

Flow data

VALVE SIZE	MV200 CV	MV608 CV	MV609 CV
1/8	1.3	1.2	1.4
1/4	4.0	5.8	4.3
3/8	3.7	3.9	3.6
1/2	5.8	5.6	6.0

Mini Ball Valves Series 200/608/609

Female Pipe Ends, Lever Handle, Mini Ball Valve MV200

PART NO.	PIPE THREAD	HEX	B	C	H	L	FLOW DIA.D
MV200-2	1/8	.83	1.71	1.20	.91	2.83	.31
MV200-4	1/4	.83	1.71	1.20	.91	2.83	.31
MV200-6	3/8	.83	1.71	1.20	.91	2.83	.31
MV200-8	1/2	.98	2.11	1.28	1.10	2.83	.39

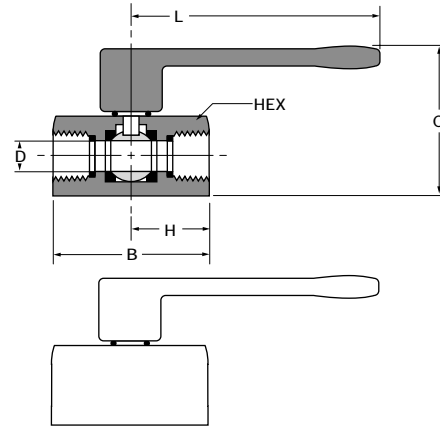

Male-Female Pipe Ends, Compact Handle, Mini Ball Valve MV608

PART NO.	PIPE THREAD	A HEX	B	C	FLOW DIA.D
MV608-2	1/8	.83	1.72	1.12	.240
MV608-4	1/4	.83	1.72	1.12	.300
MV608-6	3/8	.83	1.72	1.12	.300
MV608-8	1/2	.98	2.11	1.20	.380

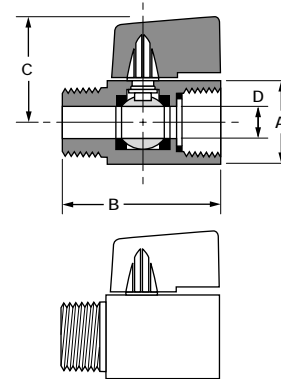

Female Pipe Ends, Compact Handle, Mini Ball Valve MV609

PART NO.	PIPE THREAD	A HEX	B	C	FLOW DIA.D
MV609-2	1/8	.83	1.72	1.12	.240
MV609-4	1/4	.83	1.72	1.12	.300
MV609-6	3/8	.83	1.72	1.12	.300
MV609-8	1/2	.98	2.11	1.20	.380
MV609-6-4	3/8x1/4	.83	1.72	1.12	.300

