

Garden Hose Fittings

Advantages

All fitting pipe threads are made to Dryseal standards. Connectors, unions, nuts and extruded elbows and tees are machined from CA 360 and CA 345 brass.

Temperature and Working Pressure Ranges

From +35°F. to +100°F. at 75 PSI maximum or the recommended working pressure of garden hose. (not to exceed 150 PSI.)

Note: 90GH is intended for use with 97HC hose clamp or crimped ferrule.

Note: All female connector ends should have a rubber washer (901GH-12) inserted prior to usage.

Order

By part number and name.

Nomenclature

Part numbers are constructed from symbols that identify the style and size of the fitting. The first series of numbers and letters identifies the style and type fitting. The second series of numbers describes the size.

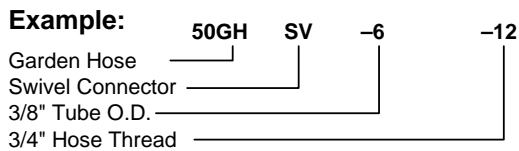

Sizes

Pipe sizes are determined by the number of sixteenths of an inch in the pipe size.

Pricing

Only items priced in current supplementary price list PL3501 are carried in stock. Price and delivery for non-stock items furnished on request for specified quantity.

Garden Hose Fittings

Swivel connector SAE flare to female hose thread 50GHSV

| PART NO. | TUBE SIZE | HOSE THREAD | L | M | FLOW DIA.D |
|-------------|-----------|-------------|------|------|------------|
| 50GHSV-6-12 | 3/8 | 3/4 | 1.25 | 1.15 | .297 |
| 50GHSV-8-12 | 1/2 | 3/4 | 1.34 | 1.15 | .406 |

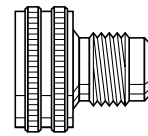
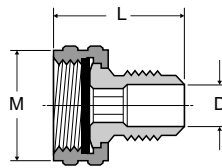

Hose barb to male hose thread 53GH, 54GH & 55GH

| PART NO. | I.D. HOSE SIZE | HOSE THREAD | C HEX | L | FLOW DIA.D |
|------------|----------------|-------------|--------|------|------------|
| 53GH-8-12 | 1/2 | 3/4 | 1-1/16 | 1.88 | .375 |
| 54GH-10-12 | 5/8 | 3/4 | 1-1/16 | 1.88 | .500 |
| 55GH-12-12 | 3/4 | 3/4 | 1-1/16 | 1.88 | .625 |

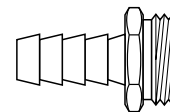
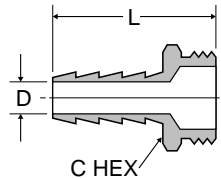

Male hose to male pipe 69GH, 70GH, 71GH

| PART NO. | HOSE THREAD | PIPE THREAD | C HEX | L | FLOW DIA.D |
|------------|-------------|-------------|--------|------|------------|
| 69GH-12-6 | 3/4 | 3/8 | 1-1/16 | 1.25 | .406 |
| 70GH-12-8 | 3/4 | 1/2 | 1-1/16 | 1.39 | .531 |
| 71GH-12-12 | 3/4 | 3/4 | 1-1/16 | 1.41 | .750 |

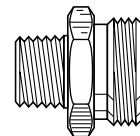
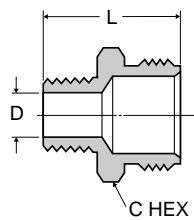

Male hose to male hose 75GH

| PART NO. | HOSE THREAD | C HEX | L | FLOW DIA.D |
|----------|-------------|--------|------|------------|
| 75GH-12 | 3/4 | 1-1/16 | 1.25 | .750 |

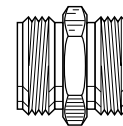
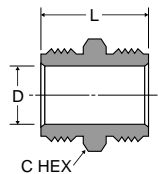

Male hose to female pipe 78GH, 79GH, 80GH & 81GH

| PART NO. | HOSE THREAD | PIPE THREAD | C HEX | L | FLOW DIA.D |
|------------|-------------|-------------|--------|------|------------|
| 78GH-12-4 | 3/4 | 1/4 | 1-1/16 | .75 | .422 |
| 79GH-12-6 | 3/4 | 3/8 | 1-1/16 | .75 | .562 |
| 80GH-12-8 | 3/4 | 1/2 | 1-1/16 | .75 | .687 |
| 81GH-12-12 | 3/4 | 3/4 | 1-3/16 | 1.28 | .719 |

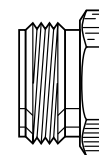
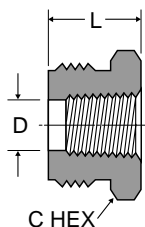

Female hose to male pipe 82GH & 83GH

| PART NO. | HOSE THREAD | PIPE THREAD | C HEX | L | FLOW DIA.D |
|------------|-------------|-------------|--------|------|------------|
| 82GH-12-8 | 3/4 | 1/2 | 1-3/16 | 1.20 | .562 |
| 83GH-12-12 | 3/4 | 3/4 | 1-3/16 | 1.22 | .750 |

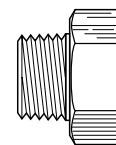
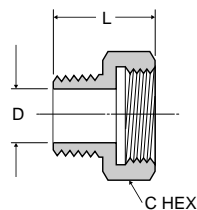

Special filter adapter 84GH

| PART NO. | HOSE THREAD | PIPE THREAD | C HEX | L | FLOW DIA.D |
|----------|-------------|-------------|-------|------|------------|
| 84GH-8-8 | 1/2 | 1/2 | 15/16 | 1.53 | .530 |

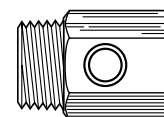
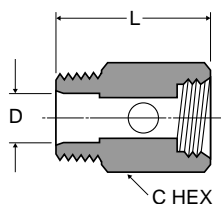

Swivel connector female garden hose to male pipe 88GH

| PART NO. | HOSE THREAD | PIPE THREAD | L | M | FLOW DIA.D |
|-----------|-------------|-------------|------|------|------------|
| 88GH-12-4 | 3/4 | 1/4 | 1.60 | 1.15 | .312 |
| 88GH-12-6 | 3/4 | 3/8 | 1.54 | 1.15 | .406 |

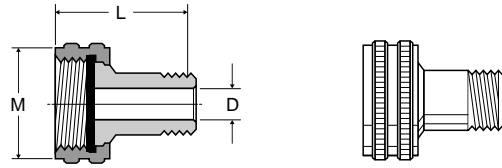

Swivel connector female garden hose to hose barb 90GH

| PART NO. | HOSE THREAD | I.D. HOSE SIZE | L | M | FLOW DIA.D |
|------------|-------------|----------------|------|------|------------|
| 90GH-12-3 | 3/4 | 3/16 | 1.29 | 1.15 | .125 |
| 90GH-12-4 | 3/4 | 1/4 | 1.21 | 1.15 | .187 |
| 90GH-12-6 | 3/4 | 3/8 | 1.21 | 1.15 | .281 |
| 90GH-12-8 | 3/4 | 1/2 | 1.21 | 1.15 | .375 |
| 90GH-12-10 | 3/4 | 5/8 | 1.93 | 1.19 | .500 |
| 90GH-12-12 | 3/4 | 3/4 | 1.93 | 1.19 | .625 |

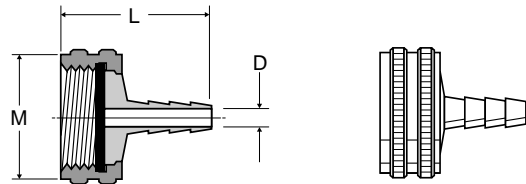

Knurled hose nut 94GH

| PART NO. | HOSE THREAD | L | M | FLOW DIA.D |
|----------|-------------|-----|------|------------|
| 94GH-12 | 3/4 | .57 | 1.15 | .808 |

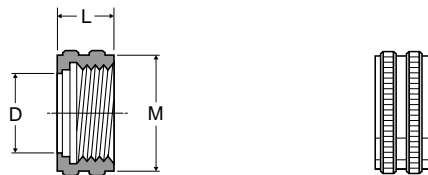

Hose nut reducer 95GH

| PART NO. | HOSE THREAD | PIPE THREAD | C HEX | L |
|-----------|-------------|-------------|-------|-----|
| 95GH-12-2 | 3/4 | 1/8 | 1-1/8 | .63 |

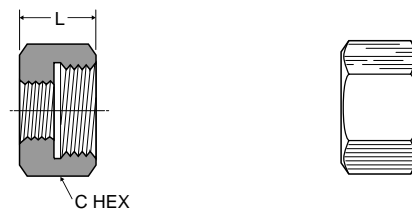

Hose cap nut 96GH

| PART NO. | HOSE THREAD | L | M |
|----------|-------------|-----|------|
| 96GH-12 | 3/4 | .50 | 1.15 |

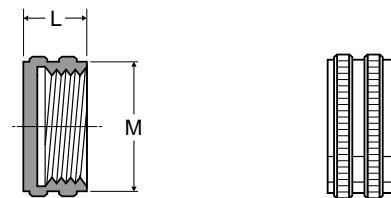

Female hose to female pipe 98GH & 99GH

| PART NO. | HOSE THREAD | PIPE THREAD | C HEX | L | M | FLOW DIA.D |
|------------|-------------|-------------|--------|------|------|------------|
| 98GH-12-8 | 3/4 | 1/2 | 1-3/16 | 1.14 | 1.01 | .687 |
| 99GH-12-12 | 3/4 | 3/4 | 1-3/16 | 1.25 | 1.17 | .750 |

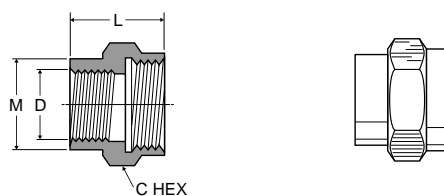

Swivel connector female hose to female pipe 98GHSV & 99GHSV

| PART NO. | HOSE THREAD | PIPE THREAD | C HEX | L | M | FLOW DIA.D |
|--------------|-------------|-------------|--------|------|------|------------|
| 98GHSV-12-8 | 3/4 | 1/2 | 1 | 1.27 | 1.21 | .687 |
| 99GHSV-12-12 | 3/4 | 3/4 | 1-3/16 | 1.34 | 1.21 | .687 |

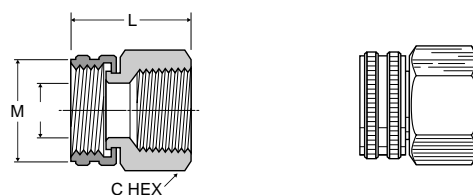

Garden Hose Fittings

Swivel nut connector 101GHSV

| PART NO. | HOSE THREAD | L | M | FLOW DIA.D |
|------------|-------------|------|------|------------|
| 101GHSV-12 | 3/4 | 1.25 | 1.15 | .625 |

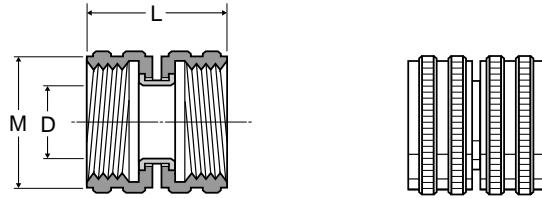

Rubber garden hose coupling washer 901GH

| PART NO. | HOSE THREAD |
|----------|-------------|
| 901GH-12 | 3/4 |

NOTE: All female connector ends should have this rubber washer installed prior to usage.



Hydraulic Quick Couplings/High Flow Couplings

Applications

Parker Water Service Couplings are used anywhere water hoses are connected and disconnected frequently. They are used on a wide variety of applications including garden hoses, wash down systems, and mobile water tank lines. The unvalved design permits maximum flow with minimum pressure drop.

Features

- Brass and stainless steel construction for heavy duty service.
- Durable 4-ball locking mechanism for secure connections.
- Quality, temperature-resistant nitrile seals for a leak-free service life.

Specifications

| | |
|-------------------------------|-----------------|
| Body Size | 3/4" |
| Rated Pressure (PSI) | 200 |
| Rated Flow (GPM) | 28 |
| Temperature Range (std seals) | -40°F to +250°F |

High flow coupler 1163-60-BPD

| PART NO. | BODY SIZE | THREAD SIZE NH | A | C |
|-------------|-----------|----------------|------|------|
| 1163-60-BPD | 3/4 | 3/4-11 1/2 | 1.12 | 1.21 |

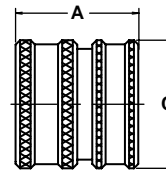

High flow nipple 1163-61-BPD

| PART NO. | BODY SIZE | THREAD SIZE NH | D | E |
|-------------|-----------|----------------|------|-----|
| 1163-61-BPD | 3/4 | 3/4-11 1/2 | 1.25 | .50 |

